

# INDUSTRIAL HOSES - metal

## Elbows



### 3D type

Material: P235 carbon steel, AISI 321 steel

90° elbow weld-in ends, compliant with PN-EN 10253 standard. Used as angular connection of metal and rubber hoses flanged or threaded ends. Safety factor 4:1.

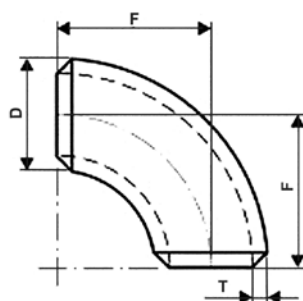

code (carbon steel)	D diameter [mm]	T thickness [mm]	F radius [mm]	working pressure [bar]	hose DN [mm]
TB-KH90-021X2,0	21.3	2	29	139	15
TB-KH90-026X2,3	26.9	2.3	29	100	20
TB-KH90-033X2,6	33.7	2.6	38	92	25
TB-KH90-042X2,6	42.4	2.6	48	82	32
TB-KH90-048X2,6	48.3	2.6	57	72	40
TB-KH90-060X2,9	60.3	2.9	76	66	50
TB-KH90-076X2,9	76.1	2.9	95	52	65
TB-KH90-088X3,2	88.9	3.2	114	49	80
TB-KH90-114X3,6	114.3	3.6	152	43	100
TB-KH90-139X4,0	139.7	4	190	39	125
TB-KH90-168X4,5	168.3	4.5	229	37	150

code (AISI 321 steel)	D diameter [mm]	T thickness [mm]	F radius [mm]	working pressure [bar]	hose DN [mm]
TB-KH90-021X2,0-SS	21.3	2	29	130	15
TB-KH90-026X2,3-SS	26.9	2.3	29	93	20
TB-KH90-033X2,6-SS	33.7	2.6	38	86	25
TB-KH90-042X2,6-SS	42.4	2.6	48	76	32
TB-KH90-048X2,6-SS	48.3	2.6	57	67	40
TB-KH90-060X2,9-SS	60.3	2.9	76	61	50
TB-KH90-076X2,9-SS	76.1	2.9	95	48	65
TB-KH90-088X3,2-SS	88.9	3.2	114	45	88
TB-KH90-114X3,6-SS	114.3	3.6	152	40	100
TB-KH90-139X4,0-SS	139.7	4	190	37	125
TB-KH90-168X4,5-SS	168.3	4.5	229	34	150