

# INDUSTRIAL FITTINGS - couplings

## Symmetrical couplings STORZ

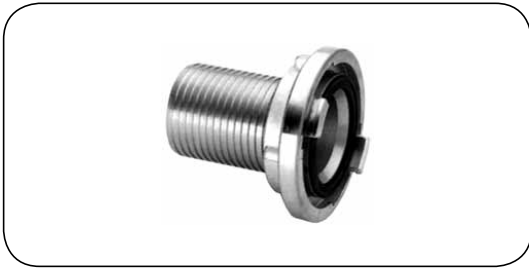

### Coupling with serrated hose tail

**Material:** Aluminium (Al), brass (Ms), stainless steel (SS)  
**Working press.:** 16 bar  
**Seal:** White NBR rubber for aluminium, black NBR rubber for brass, Viton for stainless steel

code (aluminium)	code (brass)	code (stainless steel)	size	lug dimension KA [mm]	hose diam. D [mm]	length L Al / Ms / SS [mm]
ST-12-031013-11	-	-	25-D	31	15/13	55 / - / -
ST-12-031019-11	ST-12-031019-30	ST-12-031019-43			21/19	55 / 55 / 55
ST-14-066052-11	-	-	52-C	66	51	90 / - / -
ST-14-089076-11	-	-	75-B	89	76	125 / - / -
ST-14-133102-11	-	-	110-A	133	102	170 / - / -
ST-14-133110-11	-	-			110	170 / - / -
ST-14-148127-11	-	-	125	148	127	190 / - / -
ST-14-160152-11	-	-	150	160	152	180 / - / -

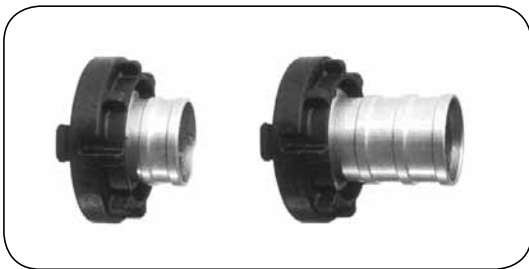

### Coupling with hose tail and plastic head

**Head material:** High performance plastic  
**Tail material:** Aluminium (Al)  
**Working press.:** 10 bar  
**Seal:** Black NBR rubber

code	size	lug dimension KA [mm]	hose diameter D [mm]	length L [mm]
ST-12-066019-60	52-C	66	19	90
ST-12-066025-60			25	90
ST-12-066032-60			32	90
ST-12-066038-60			38	90
ST-12-066040-60			40	90
ST-11-066042-65*			42	55
ST-12-066042-60			42	90
ST-11-066045-65*			45	70
ST-12-066045-60			45	90
ST-12-066050-60			50	90
ST-11-066052-65*			52	55
ST-12-066052-60			52	90
ST-12-066055-60			55	90
ST-12-066060-60			60	90

\* - coupling with a shorter hose tail