

INDUSTRIAL PNEUMATICS - air treatment units

SKILLAIR series

SKILLAIR series allows any combination of shut-off valves, filters, regulators, lubricators, branching modules. Each element can be disassembled without the need to disconnect supply pipes.

Using SKILLAIR series it is possible to create a unit consisting of several FRL elements according to customer specifications. To combine these elements, one or more connection sets must be used. To get the required inlet and outlet connection, the appropriate set of final plates should be used.

An example of FRL unit

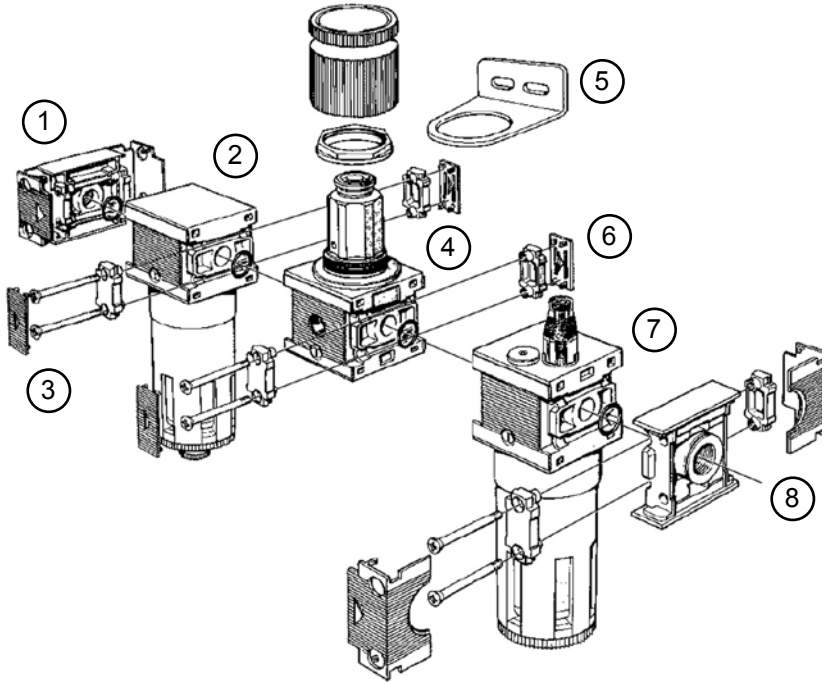

- 1, 8 - final plates (set)
- 2 - filter (FIL)
- 3, 6 - connection sets
- 4 - regulating valve (REG)
- 5 - mounting bracket to the wall
- 7 - lubricator (LUB)

The direction of air flow must be compatible with the direction pointed by the arrows on the elements.

series (size)				connection (BSP female)
100	200	300	400	
connection set				-
MW-9230301	MW-9330301	MW-9430301	MW-9630301	-
final plates set *				-
MW-9230401	MW-9330601	-	-	1/4"
MW-9330501	MW-9330701	-	-	3/8"
-	MW-9330801	MW-9430701	-	1/2"
-	-	MW-9530901	-	3/4"
-	-	MW-9531001	MW-9631001	1"
-	-	-	MW-9631101	1.1/4"
-	-	-	MW-9631201	1.1/2"
-	-	-	MW-9631301	2"

* - with input and output connection

An example of FRL SKILLAIR 200 series unit consisting of:

- filter-reducer (FR) - adjustable in the range 0 ÷ 12 bar, filtration 20 µm and RMSA condensate drain,
- lubricator (LUB),
- final plates set with 1/2" connections and connection set.

final plates set	filter-regulator (FR)	connection set	lubricator (LUB)
MW-9330801	MW-3483011A	MW-9330301	MW-3481001A