

HIGH PRESSURE - hydraulic cylinders

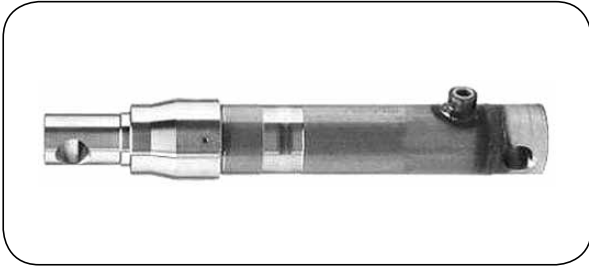

SE 45, SE 50, SE 55, SE 60 type

Material: Carbon steel
Sealing: PU, POM, NBR
Protective coating: No coating, chromium-plated piston rod
Medium: Hydraulic oil
Max. working press.: 210 bar
Working temp.: From -30°C up to +110°C

Single-acting hydraulic cylinder with a threaded head, designed for high pressure hydraulic systems. Depending on the application, appropriate cylinder output force (given in kg/100 bar) and stroke LC must be selected. Seal sets are available on request.

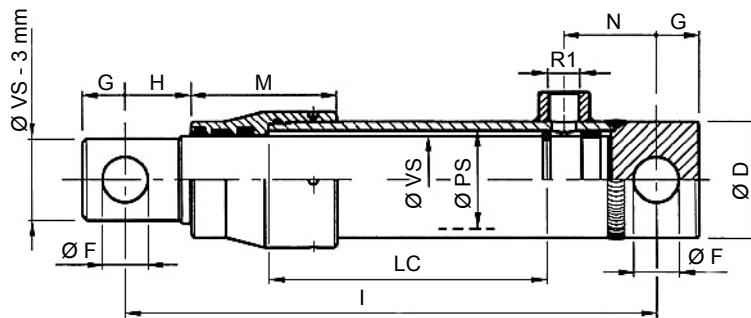

code	Ø VS [mm]	Ø PS [mm]	Ø D [mm]	Ø F [mm]	M [mm]	R1 [BSP]	G [mm]	H [mm]	N [mm]	LC [mm]	I [mm]	kg/100 bar	weight [kg]
SE 45 type													
HS-SE45200	45	50	60	23.4	75	3/8"	22	34	47	200	330	1590	8.00
HS-SE45300										300	430		10.00
HS-SE45400										400	530		12.00
HS-SE45550										550	680		15.00
HS-SE45700										700	830		18.00
SE 50 type													
HS-SE50200	50	55	65	25.5	80	3/8"	25	49	50	200	360	1960	11.50
HS-SE50300										300	460		14.00
HS-SE50400										400	560		16.00
HS-SE50550										550	710		19.50
HS-SE50700										700	860		23.00
SE 55 type													
HS-SE55300	55	60	70	25.5	95	3/8"	25	41	50	300	460	2370	15.50
HS-SE55550										550	710		22.50
HS-SE55700										700	860		26.50
SE 60 type													
HS-SE60200	60	65	75	25.5	95	3/8"	25	36	50	200	360	2820	15
HS-SE60300										300	460		18
HS-SE60400										400	560		21
HS-SE60550										550	710		25.5
HS-SE60700										700	860		30