

# HIGH PRESSURE - DIN 2353 connectors

## DIN 2353 Eaton Walterscheid™

description	series	press. [bar]	code (galvanized steel)	D1 [mm]	M1 [mm]	D2 [mm]	M2 [mm]	
Straight reducing connector	L	500	HD-KORO-08-06L-W	8	14x1.5	6	12x1.5	
			HD-KORO-10-06L-W	10	16x1.5	6	12x1.5	
			HD-KORO-10-08L-W	10	16x1.5	8	14x1.5	
		400	HD-KORO-12-06L-W	12	18x1.5	6	12x1.5	
			HD-KORO-12-08L-W	12	18x1.5	8	14x1.5	
			HD-KORO-12-10L-W	12	18x1.5	10	16x1.5	
			HD-KORO-15-06L-W	15	22x1.5	6	12x1.5	
			HD-KORO-15-08L-W	15	22x1.5	8	14x1.5	
			HD-KORO-15-10L-W	15	22x1.5	10	16x1.5	
			HD-KORO-15-12L-W	15	22x1.5	12	18x1.5	
			HD-KORO-18-06L-W	18	26x1.5	6	12x1.5	
			HD-KORO-18-08L-W	18	26x1.5	8	14x1.5	
			HD-KORO-18-10L-W	18	26x1.5	10	16x1.5	
			HD-KORO-18-12L-W	18	26x1.5	12	18x1.5	
			HD-KORO-18-15L-W	18	26x1.5	15	22x1.5	
			250	HD-KORO-22-06L-W	22	30x2	6	12x1.5
				HD-KORO-22-08L-W	22	30x2	8	14x1.5
		HD-KORO-22-10L-W		22	30x2	10	16x1.5	
		HD-KORO-22-12L-W		22	30x2	12	18x1.5	
		HD-KORO-22-15L-W		22	30x2	15	22x1.5	
		HD-KORO-22-18L-W		22	30x2	18	26x1.5	
		HD-KORO-28-06L-W		28	36x2	6	12x1.5	
		HD-KORO-28-08L-W		28	36x2	8	14x1.5	
		HD-KORO-28-10L-W		28	36x2	10	16x1.5	
		HD-KORO-28-12L-W		28	36x2	12	18x1.5	
		HD-KORO-28-15L-W		28	36x2	15	22x1.5	
		HD-KORO-28-18L-W		28	36x2	18	26x1.5	
		HD-KORO-28-22L-W		28	36x2	22	30x2	
		HD-KORO-35-06L-W		35	45x2	6	12x1.5	
		HD-KORO-35-08L-W		35	45x2	8	14x1.5	
		HD-KORO-35-10L-W		35	45x2	10	16x1.5	
		HD-KORO-35-12L-W		35	45x2	12	18x1.5	
		HD-KORO-35-15L-W		35	45x2	15	22x1.5	
		HD-KORO-35-18L-W		35	45x2	18	26x1.5	
		HD-KORO-35-22L-W		35	45x2	22	30x2	
		HD-KORO-35-28L-W	35	45x2	28	36x2		
		HD-KORO-42-06L-W	42	52x2	6	12x1.5		
		HD-KORO-42-08L-W	42	52x2	8	14x1.5		
		HD-KORO-42-10L-W	42	52x2	10	16x1.5		
		HD-KORO-42-12L-W	42	52x2	12	18x1.5		
		HD-KORO-42-15L-W	42	52x2	15	22x1.5		
		HD-KORO-42-18L-W	42	52x2	18	26x1.5		
		HD-KORO-42-22L-W	42	52x2	22	30x2		
		HD-KORO-42-28L-W	42	52x2	28	36x2		
		HD-KORO-42-35L-W	42	52x2	35	45x2		

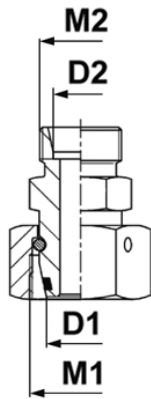

**KORO - L**