

CAMLOCK connectors

ERS type

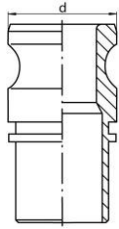

CAMLOCK connector plug with end for shell bracket EN 14420-3



stainless steel AISI 316

CRS type

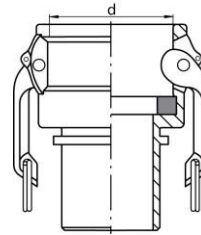

Socket for CAMLOCK connector with end for shell bracket EN 14420-3



stainless steel AISI 316

size				plug index (AISI 316 steel)	socket index (AISI 316 steel)
DN [mm].	connector [inch]	d (plug) [mm].	Hose inside diameter [mm]		
15	1/2	~ 24	13	AC-ERS-050-SS AC-ERS-050-SSX	AC-CRS-050-SS* AC-CRS-050-SSX
20	3/4	32,1	19	AC-ERS-075-SS AC-ERS-075-SSX	AC-CRS-075-SS* AC-CRS-075-SSX
25	1	36,7	25	AC-ERS-100-SS* AC-ERS-100-SSX	AC-CRS-100-SS* AC-CRS-100-SSX
32	1.1/4	45,5	32	AC-ERS-125-SS AC-ERS-125-SSX	AC-CRS-125-SS* AC-CRS-125-SSX
40	1.1/2	53,4	38	AC-ERS-150-SS* AC-ERS-150-SSX	AC-CRS-150-SS* AC-CRS-150-SSX
50	2	63	50	AC-ERS-200-SS* AC-ERS-200-SSX	AC-CRS-200-SS* AC-CRS-200-SSX
65	2.1/2	75,8	63 (65*)	AC-ERS-250-SS* AC-ERS-250-SSX	AC-CRS-250-SS* AC-CRS-250-SSX
80	3	91,5	75	AC-ERS-300-SS* AC-ERS-300-SSX	AC-CRS-300-SS* AC-CRS-300-SSX
100	4	119,5	100	AC-ERS-400-SS AC-ERS-400-SSX	AC-CRS-400-SS AC-CRS-400-SSX

* - available with E-CTFE lining, example index: AC-ERS-100-SSE, AC-CRS-100-SSE

Note: The inside diameter of the hose to which the nozzle will be fitted should not deviate too much from the table above. This applies particularly to hoses made of harder plastics or with a hard polymer spout (e.g. UPE), where too much clearance between the nozzle and the hose can cause leakage.



CAMLOCK connector plug and socket type ERS and CRS 1" in AISI 316 steel mounted to CHEMSTAR UPE SD DN25 hose (SO-CHEMSTAR-UPE-SD- 025) using an aluminium shell clamp to EN 14420-3 / DIN 2817 (RS- 636025006040).

Smooth "tail" with lock under the shell bracket