

**CAMLOCK connectors**

**AU type**

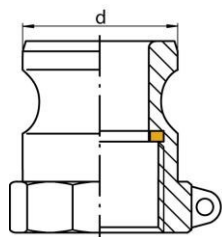

**CAMLOCK connector plug**  
with BSP female thread ISO-228-1



Aluminium  
(polyurethane flat seal)



stainless steel AISI 316  
(PTFE flat seal)



DN [mm]	connector [inch]	size		index (aluminium)	index (AISI 316 steel)
		d [mm]	thread d [inch]		
15	1/2	~ 24	1/2	AC-AU-050-A AC-AU-050-AX	AC-AU-050-SS AC-AU-050-SSX
20	3/4	32,1	3/4	AC-AU-075-A AC-AU-075-AX	AC-AU-075-SS AC-AU-075-SSX
25	1	36,7	1	AC-AU-100-A AC-AU-100-AX	AC-AU-100-SS* AC-AU-100-SSX
32	1.1/4	45,5	1.1/4	AC-AU-125-A AC-AU-125-AX	AC-AU-125-SS AC-AU-125-SSX
40	1.1/2	53,4	1.1/2	AC-AU-150-A AC-AU-150-AX	AC-AU-150-SS* AC-AU-150-SSX
50	2	63	2	AC-AU-200-A AC-AU-200-AX	AC-AU-200-SS* AC-AU-200-SSX
65	2.1/2	75,8	2.1/2	AC-AU-250-A AC-AU-250-AX	AC-AU-250-SS AC-AU-250-SSX
80	3	91,5	3	AC-AU-300-A AC-AU-300-AX	AC-AU-300-SS* AC-AU-300-SSX
100	4	119,5	4	AC-AU-400-A AC-AU-400-AX	AC-AU-400-SS* AC-AU-400-SSX
125	5	145,6	5	AC-AU-500-A AC-AU-500-AX	AC-AU-500-SS AC-AU-500-SSX
150	6	176	6	AC-AU-600-A AC-AU-600-AX	AC-AU-600-SS AC-AU-600-SSX

\* - available with E-CTFE lining, example index: AC-AU-100-SSE



CAMLOCK coupling plug type AU 3" in aluminium mounted to OIL STAR SD hose (SO-OILSTAR-SD-076) by means of an aluminium coupling with protective collar for hose with male thread (butt seal) type VSL (GD-VSLB-080-075-AL) bolted with a shell clip in accordance with EN 14420-3 (TI-SC-075-060-AL).