

CAMLOCK connectors
Type A

CAMLOCK connector plug with BSP or NPT female thread

aluminium

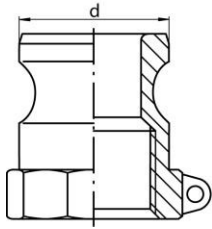

brass



stainless steel AISI 316



polypropylene

| DN [mm] | size | | | index (aluminium) | index (brass) | index (AISI 316 steel) | index (polypropylene) |
|---------|------------------|--------|---------------|-----------------------------------|---------------------------|-------------------------------------|-----------------------|
| | connector [inch] | d [mm] | thread [inch] | | | | |
| 15 | 1/2 | ~ 24 | 1/2 BSP | AC-A-050-A AC-A-050-AX | AC-A-050-B AC-A-050-BX | AC-A-050-SS AC-A-050-SSX | - - |
| 15 | 1/2 | ~ 24 | 1/2 NPT | - - | - - | AC-A-050-SS-NPT AC-A-050-SSX-NPT | - - |
| 20 | 3/4 | 32,1 | 1/2 BSP | - - | - - | - - | AC-A-050-P - |
| 20 | 3/4 | 32,1 | 3/4 BSP | AC-A-075-A AC-A-075-AX | AC-A-075-B AC-A-075-BX | AC-A-075-SS AC-A-075-SSX | AC-A-075-P - |
| 20 | 3/4 | 32,1 | 3/4 NPT | AC-A-075-A-NPT AC-A-075-AX-NPT | - - | AC-A-075-SS-NPT AC-A-075-SSX-NPT | - - |
| 25 | 1 | 36,7 | 1.1/4 BSP | - - | - - | - - | AC-A-125-P - |
| 25 | 1 | 36,7 | 1 BSP | AC-A-100-A AC-A-100-AX | AC-A-100-B AC-A-100-BX | AC-A-100-SS AC-A-100-SSX | AC-A-100-P - |
| 25 | 1 | 36,7 | 1 NPT | AC-A-100-A-NPT AC-A-100-AX-NPT | - - | AC-A-100-SS-NPT AC-A-100-SSX-NPT | - - |
| 32 | 1.1/4 | 45,5 | 1.1/4 BSP | AC-A-125-A AC-A-125-AX | AC-A-125-B AC-A-125-BX | AC-A-125-SS AC-A-125-SSX | - - |
| 32 | 1.1/4 | 45,5 | 1.1/4 NPT | - - | - - | AC-A-125-SS-NPT AC-A-125-SSX-NPT | - - |
| 40 | 1.1/2 | 53,4 | 1.1/2 BSP | AC-A-150-A AC-A-150-AX | AC-A-150-B AC-A-150-BX | AC-A-150-SS AC-A-150-SSX | AC-A-150-P = |
| 50 | 2 | 63 | 2 BSP | AC-A-200-A AC-A-200-AX | AC-A-200-B AC-A-200-BX | AC-A-200-SS AC-A-200-SSX | AC-A-200-P - |
| 50 | 2 | 63 | 2 NPT | - - | - - | AC-A-200-SS-NPT AC-A-200-SSX-NPT | - - |
| 50 | 2 | 63 | 3 BSP | AC-A-200-300-A AC-A-200-300-AX | - - | - - | - - |
| 65 | 2.1/2 | 75,8 | 2.1/2 BSP | AC-A-250-A AC-A-250-AX | AC-A-250-B AC-A-250-BX | AC-A-250-SS AC-A-250-SSX | - - |
| 80 | 3 | 91,5 | 2 BSP | - AC-A-300-200-AX | - - | - - | - - |
| 80 | 3 | 91,5 | 3 BSP | AC-A-300-A AC-A-300-AX | AC-A-300-B AC-A-300-BX | AC-A-300-SS AC-A-300-SSX | AC-A-300-P - |
| 80 | 3 | 91,5 | 3 NPT | AC-A-300-A-NPT AC-A-300-AX-NPT | - - | AC-A-300-SS-NPT AC-A-300-SSX-NPT | - - |
| 80 | 3 | 91,5 | 4 BSP | - AC-A-300-400-AX | - - | - - | - - |
| 100 | 4 | 119,5 | 3 BSP | - AC-A-400-300-AX | - - | - - | - - |
| 100 | 4 | 119,5 | 4 BSP | AC-A-400-A AC-A-400-AX | AC-A-400-B AC-A-400-BX | AC-A-400-SS AC-A-400-SSX | AC-A-400-P = |
| 100 | 4 | 119,5 | 4 NPT | - - | - - | AC-A-400-SS-NPT AC-A-400-SSX-NPT | - - |
| 100 | 4 | 119,5 | 6 BSP | - AC-A-400-600-AX | - - | - - | - - |
| 125 | 5 | 145,6 | 5 BSP | AC-A-500-A AC-A-500-AX | AC-A-500-B AC-A-500-BX | AC-A-500-SS AC-A-500-SSX | - - |
| 150 | 6 | 176 | 4 BSP | - AC-A-600-400-AX | - - | - - | - - |
| 150 | 6 | 176 | 6 BSP | AC-A-600-A AC-A-600-AX | AC-A-600-B AC-A-600-BX | AC-A-600-SS AC-A-600-SSX | - - |